



AREA AMENITIES

Treviso is situated in the heart of North York, directly across from the Columbus Centre with its art gallery, pool, gym and sports courts. The condominium community is located less than a five-minute wait for a bus in any direction. The Lawrence subway station is close by, Yorkdale Shopping Centre and downtown Toronto are minutes away, and Highway 401 and Allen Road are immediately accessible. This well-established neighbourhood is packed with other amenities, making it as convenient as it is beautiful.

LUXURY SUITE FINISHES & FEATURES

Treviso will ultimately consist of four residential towers to encompass an Old World-style entry boulevard, and prime retail on the ground floor. The contemporary exterior incorporates signature elements of historic Italian design. The buildings will surround Piazza Treviso - a central square with beautiful landscaping. Two pedestrian bridges will cross a waterway and link to landscaped walking paths. In the first release, Munge Leung-designed amenity spaces include the elegant lobby with 24-hour concierge; party room with formal dining room, hosting kitchen and terrazzo; equipped fitness centre with steam room and change rooms; boardroom; and an outdoor area with a swimming pool, hot tub, lounge with barbecue and alfresco dining spaces. A second-floor outdoor space will accommodate gardening plots for residents from specific suites. Most suites open onto oversized loggias (balconies) or terraces, many with planters. Features include laminate flooring, porcelain or ceramic tiles in most areas; bathrooms with a cast-stone rectangular sink; and Munge Leung-designed kitchens with granite countertops, ceramic tile backsplash, stainless steel-front appliances. Pantries are also included in most kitchen designs.

Deposit Structure

\$2000 with the offer
Balance to 5% in 30 days
5% in 120 days
5% in 270 days
5% on occupancy

Off Shore Deposit Structure

\$2000 with the offer
Balance to 7.5% in 30 days
7.5% in 120 days
7.5% in 270days
7.5% on occupancy

Projected Occupancy Date:

September 2014

Estimated Taxes:

Approx. +/- 1% of Purchase Price

Maintenance:

\$0.50 cents per sq. ft. + Hydro

Parking:

(No parking available for bachelor unit)

INCLUDED

Locker:

\$5,000

Prices and specifications are subject to change without notice. E. & O.E. October 26th, 2010

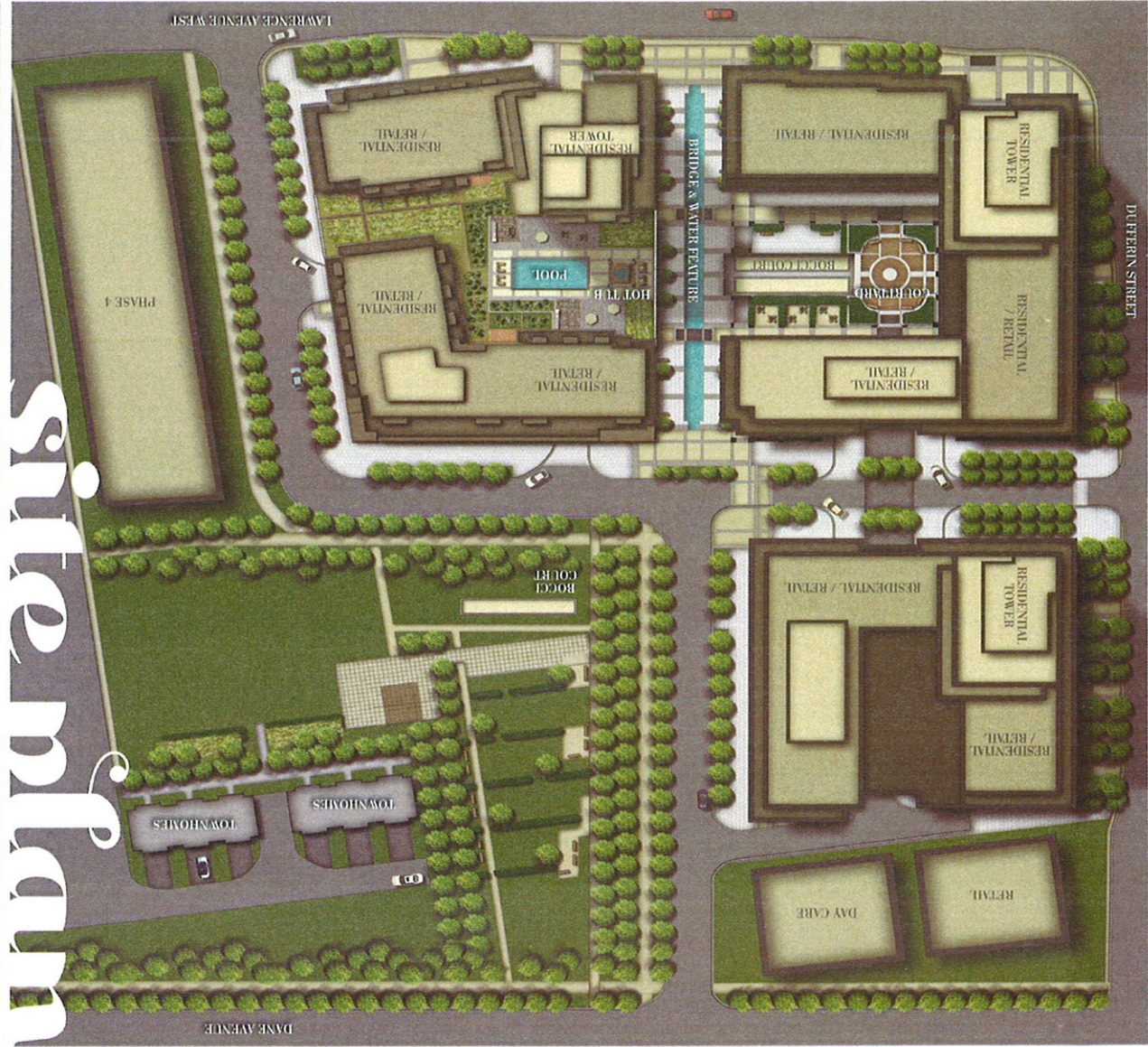



Price List

MODEL	FROM FLOORS	TYPE	APPROXIMATE SUITE SIZE	EXPOSURE	APPROXIMATE BALCONY/ TERRACE/ GARDEN SIZE	PRICES FROM
Bachelor						
Pero	2 to 8	Bachelor	382 sq. ft	South	BALCONY	\$179,900
1 Bedroom & 1 Bedroom + Study						
Sona 1 & 2	3 to 18	One Bedroom	480 sq. ft	North	BALCONY	\$216,900
Asiago	3 to 6	One Bedroom	508 sq. ft.	North	TERRACE	\$246,900
Fonte	2 to 8	One Bedroom	511 sq. ft.	East	BALCONY & TERRACE	\$242,900
Scorze	9 to 18	One Bedroom	524 sq. ft.	East	BALCONY	\$237,900
Loria	2 to 18	One Bedroom	528 sq. ft.	South	BALCONY	\$231,900
Miane	2 to 6	One Bedroom	542 sq. ft.	South & East	FRENCH BALCONY	\$242,900
Mira	3 to 6	One Bedroom	552 sq. ft.	South	TERRACE	\$265,900
Tarzo	9 to 18	One Bedroom	554 sq. ft.	East	BALCONY	\$250,900
Negrar	7 to 8	One Bedroom	554 sq. ft.	South-East	BALCONY & TERRACE	\$258,900
Spinea	2 to 8	One Bedroom	563 sq. ft.	East	BALCONY & TERRACE	\$265,900
Vidor	9 to 20	One Bedroom	580 sq. ft.	South	BALCONY	\$258,900
Resana	9 to 20	One Bedroom + Study	610 sq. ft	South-West	BALCONY	\$275,900
Paese	19 to 20	One Bedroom + Study	621 sq. ft	North	BALCONY & TERRACE	305,900
Oredezo	9 to 20	One Bedroom + Study	629 sq. ft	North-East	BALCONY	\$285,900
1 Bedroom + Den						
Asollo 1	7 to 20	One Bedroom + Den	557 sq. ft	West	BALCONY & TERRACE	\$249,900
Asollo 2	7 to 18	One Bedroom + Den	581 sq. ft.	West	BALCONY & TERRACE	\$259,900
Verona S	3 to 8	One Bedroom + Den	583 sq. ft	North	BALCONY & TERRACE	\$276,900
Santandrea	3 to 6	One Bedroom + Den	623 sq. ft	North	TERRACE	\$294,900
Verona	2 to 8	One Bedroom + Den	623 sq. ft	East & South	BALCONY & TERRACE	\$293,900
Follina	2 to 8	One Bedroom + Den	623 sq. ft	East & South & West	BALCONY & TERRACE	\$293,900
Follina B	3 to 8	One Bedroom + Den	665 sq. ft.	South	BALCONY & TERRACE	\$313,900
Asollo 1B	2 to 6	One Bedroom + Den	669 sq. ft	West	TERRACE	\$304,900
Asollo 2B	2 to 6	One Bedroom + Den	693 sq. ft.	West	TERRACE	\$314,900
Follina 2 B	7 to 8	One Bedroom + Den	697 sq. ft	South-East & South-West	BALCONY & TERRACE	\$322,900
2 Bedroom & 2 Bedroom + Study						
Fratte	2 to 6	Two Bedroom	686 sq. ft	South-East	BALCONY	\$313,900
Fratte B	3 to 6	Two Bedroom	714 sq. ft	North-East	BALCONY	\$323,900
Camalo	7 to 18	Two Bedroom	704 sq. ft	North-West	BALCONY & TERRACE	\$313,900
Istrana	3 to 6	Two Bedroom + Study	723 sq. ft	South-East & South West	TERRACE	\$338,900
San Fior	9 to 18	Two Bedroom	755 sq. ft	South-East	BALCONY	\$339,900
Martellago	19 to 20	Two Bedroom	758 sq. ft	East	BALCONY & TERRACE	\$375,900
Vazzola	3 to 8	Two Bedroom + Study	798 sq. ft.	North	BALCONY	\$325,900
Casoni	7 to 8	Two Bedroom	818 sq. ft.	South-West	BALCONY & TERRACE	\$365,900
Musano	7 to 8	Two Bedroom	821 sq. ft.	North-East	BALCONY & TERRACE	\$383,900
Levada	7 to 8	Two Bedroom	831 sq. ft.	North-East	BALCONY & TERRACE	\$393,900
Camalo B	3 to 6	Two Bedroom	847 sq. ft.	North-West	BALCONY & TERRACE	\$382,900
Chiampo	3 to 6	Two Bedroom	857 sq. ft.	South-West	BALCONY	\$377,900
Mirano	3 to 8	Two Bedroom	884 sq. ft.	North	BALCONY	\$394,900
Vedalago	3 to 8	Two Bedroom + Study	903 sq. ft.	North-East	BALCONY	\$399,900
Cittadella	2 to 6	Two Bedroom	931 sq. ft.	North-East	TERRACE & BALCONY	\$447,900



MODEL	FROM FLOORS	TYPE	APPROXIMATE SUITE SIZE	EXPOSURE	APPROXIMATE BALCONY/ TERRACE/ GARDEN SIZE	PRICES FROM:
2 Bedroom + Den						
Venezia	2 to 6	Two Bedroom + Den	885 sq. ft.	North	TERRACE	\$412,900
Fregona	2 to 6	Two Bedroom + Den	887 sq. ft.	North	TERRACE	\$412,900
Castelfranco	19 to 20	Two Bedroom + Den	919 sq. ft.	South-East	BALCONY & TERRACE	\$451,900
Sabbioni	3 to 8	Two Bedroom + Den	924 sq. ft.	West	BALCONY & TERRACE	\$439,900
Arzignano	2 to 8	Two Bedroom + Den	940 sq. ft.	South	BALCONY & TERRACE	\$423,900
Castello	7 to 8	Two Bedroom + Den	941 sq. ft.	North	BALCONY & TERRACE	\$426,900
Venezia B	3 to 8	Two Bedroom + Den	949 sq. ft.	South	BALCONY	\$424,900
Monselice	2 to 8	Two Bedroom + Den	1021 sq. ft.	South	BALCONY	\$438,900
3 Bedroom						
Villorba & Villorba B	7 to 8	Three Bedroom	953 sq. ft. / 968 sq. ft.	North	BALCONY & TERRACE	\$440,900
San Bonifascio	19 to 20	Three Bedroom	1056 sq. ft.	North-West	BALCONY & TERRACE	\$515,900
Rossetto	7 to 8	Three Bedroom	1105 sq. ft.	South-West	BALCONY & TERRACE	\$499,900
Stradazza	7 to 8	Three Bedroom	1106 sq. ft.	North-West	BALCONY & TERRACE	\$499,900
Montebellina	3 to 6	Three Bedroom	1117 sq. ft.	North-West	TERRACE	\$506,900
Legnago	2 to 6	Three Bedroom	1232 sq. ft.	South-West	TERRACE	\$559,900
Giardino Suites						
Asiago	2	One Bedroom	508 sq. ft.	North	GARDEN & TERRACE	\$260,900
Miane	2	One Bedroom	542 sq. ft.	South	GARDEN & TERRACE	\$271,900
Verona S	2	One Bedroom + Den	583 sq. ft.	North	GARDEN & TERRACE	\$290,900
Follina	2	One Bedroom + Den	620 sq. ft.	West	GARDEN & TERRACE	\$343,900
Santandra	2	One Bedroom + Den	623 sq. ft.	North	GARDEN & TERRACE	\$308,900
Follina B	2	One Bedroom + Den	665 sq. ft.	South	GARDEN & TERRACE	\$362,900
Fratta B	2	Two Bedroom	714 sq. ft.	North-East	GARDEN & TERRACE	\$372,900
Istrana	2	Two Bedroom + Study	723 sq. ft.	South-East & South-West	GARDEN & TERRACE	\$387,900
Mirano	2	Two Bedroom	884 sq. ft.	North	GARDEN & TERRACE	\$418,900
Sabbioni	2	Two Bedroom + Den	924 sq. ft.	West	GARDEN & TERRACE	\$463,900
Venezia B	2	Two Bedroom + Den	949 sq. ft.	South	GARDEN & TERRACE	\$473,900

Prices and specifications are subject to change without notice. E. & O.E. October 26th, 2010